

Access Map

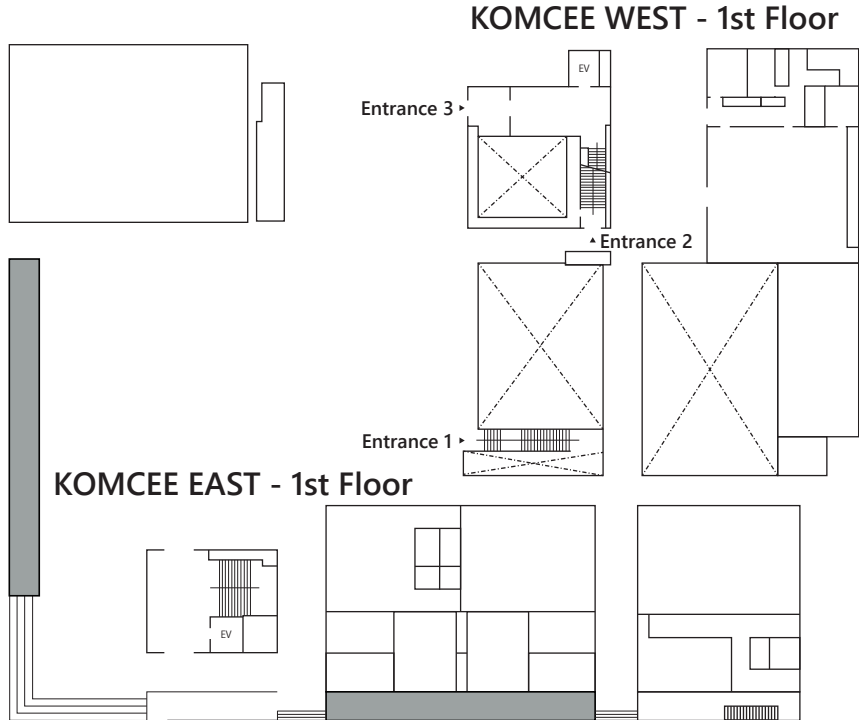

- Entrance 1: Access to Basement Level (B1F) through exterior staircase
- Entrance 2: Access to Basement Level (B1F) through staircase
- Entrance 3: Elevator Access to all floors / Access to 3F & 4F through staircase

Reminders

- Smoking is allowed in designated area only.
- Food and Drinks are only allowed in MM Hall (Exhibition Hall) and Cafeteria Area in the Basement Level (B1F)
- Water is allowed in Conference Halls and Presentation Rooms